

Yahara Headwaters Trail

Legend

- - - Proposed Trail
- - - Open Trail
- Some Blockage
- No Passage (Blocked)

Canoe Landings

1. Token Creek Co. Park
2. City of Madison Boathouse, Cherokee Conservation Park
3. Cherokee Park, Madison
4. School Road Landing, Madison
5. Yahara Heights County Dog Park
6. Jackson's Landing, Westport
7. Woodland Drive access, Westport
8. Governor Nelson State Park, Dorn Creek
9. Governor Nelson State Park boat landing
10. Mendota County Park
11. Lake Street landing, Middleton
12. Tiedemans Pond, Middleton
13. Strickler's Pond, Middleton
14. Pheasant Branch Creek Conservancy Overlook, Middleton
15. Marshall Park, Madison
16. Spring Harbour Park, Madison
17. Picnic Point, University of Wisconsin - Madison
18. James Madison Park, Madison
19. Tenney Park County Locks, Madison
20. Burr Jones Field, Madison
21. Yahara Place Park, Madison
22. Morrison Park, Madison
23. B.B. Clarke Park, Madison
24. Law Park/Monona Terrace, Madison

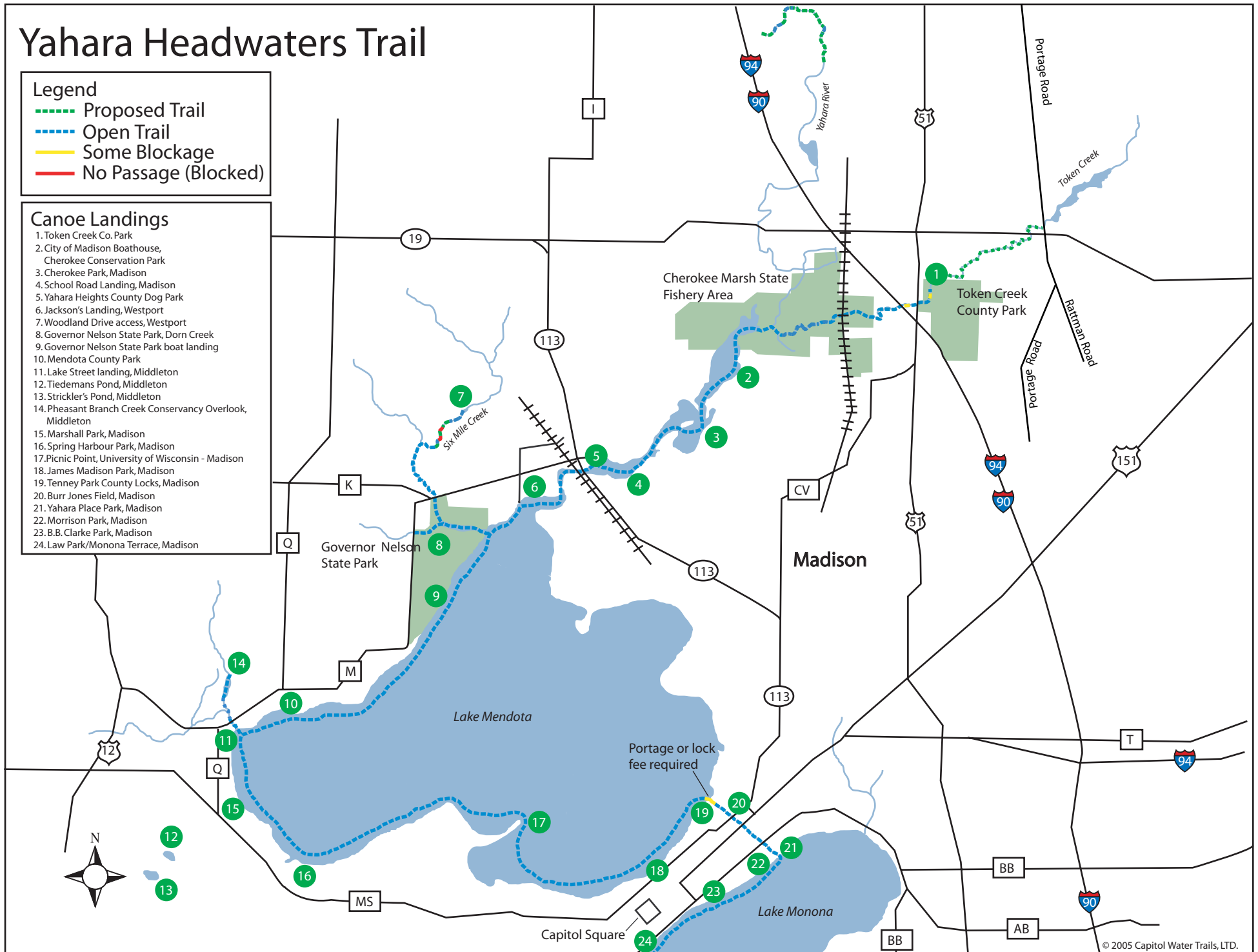

Yahara Lakes Trail

Legend

- - - Proposed Trail
- - - Open Trail
- - - Some Blockage
- - - No Passage (Blocked)

Canoe Landings

15. Marshall Park - Madison
16. Spring Harbour Park - Madison
17. Picnic Point - U.W. Madison
18. James Madison Park - Madison
19. Tenney Park - Madison
20. Burr-Jones Field - Madison
21. Yahara Place Park - Madison
22. Morrison Park - Madison
23. B.B. Clarke Park - Madison
24. Law Park - Madison
25. Olin-Turville Canoe Launch
Wingra Creek - Madison
26. Olin-Turville Point - Madison
27. Franklin Field - Madison
28. Wingra Dam Portage - Madison
29. Wingra Park - Madison
30. Paunak Park - Madison
31. Frost Woods Beach - Monona
32. Lottes Park - Monona
33. Moorland Road - Dane Co. E-Way
34. Centennial State Park
Lake Farm County Park boat landing
35. McDaniel Park - McFarland
36. Babcock County Park
37. Legion Memorial Park - McFarland
38. Dyerson Road County
Conservation Park
39. Fish Camp County Park
40. Lake Kegonsa State Park
41. LaFollette County Park

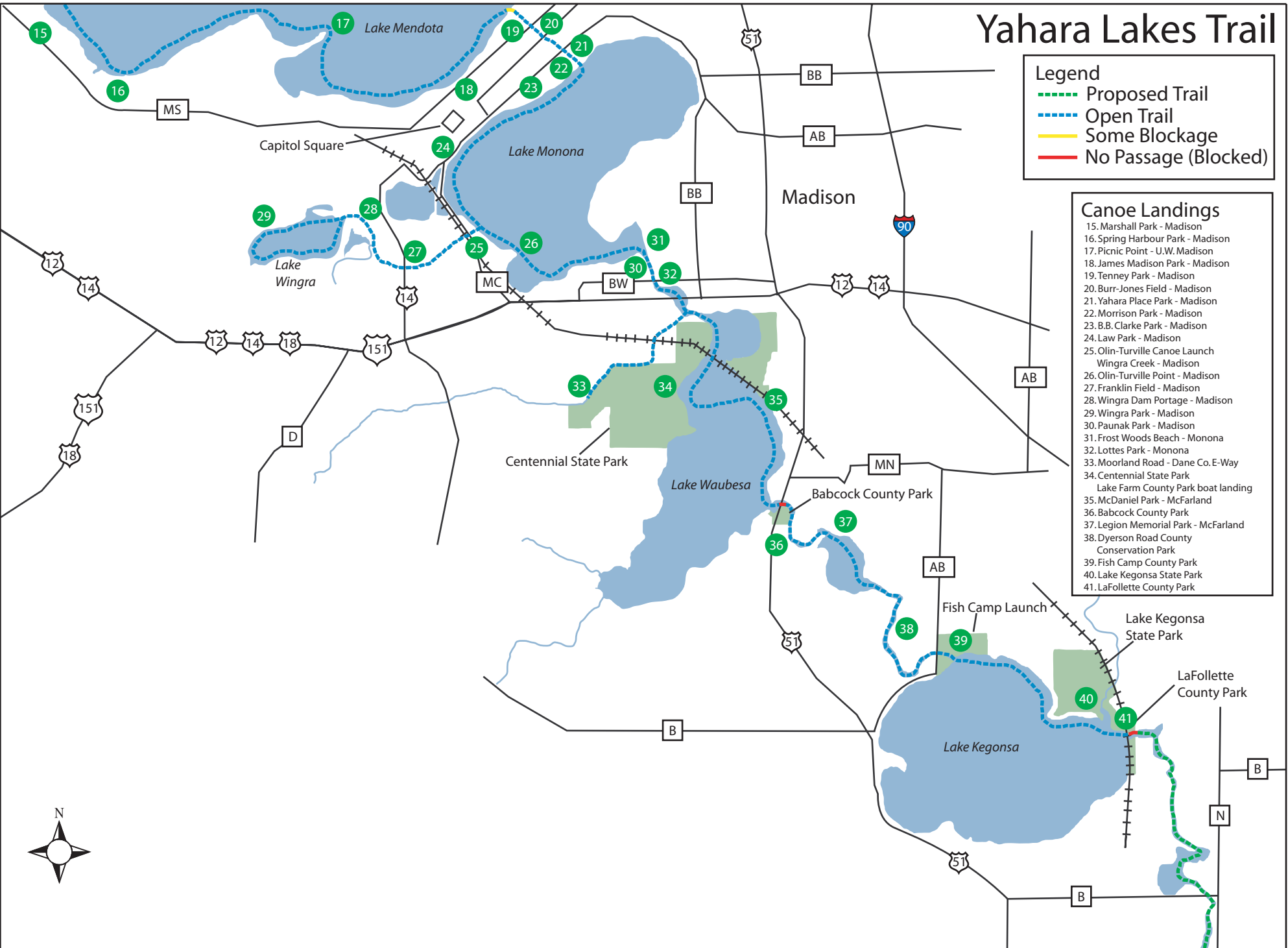

Legend

- - - Proposed Trail
- - - Open Trail
- - - Some Blockage
- - - No Passage (Blocked)

Canoe Landings

- 43. Viking County Park
- 44. Bjion Park, Stoughton
- 45. Mandt Park, Stoughton
- 46. Dunkirk Dam
- 47. Highway N Landing

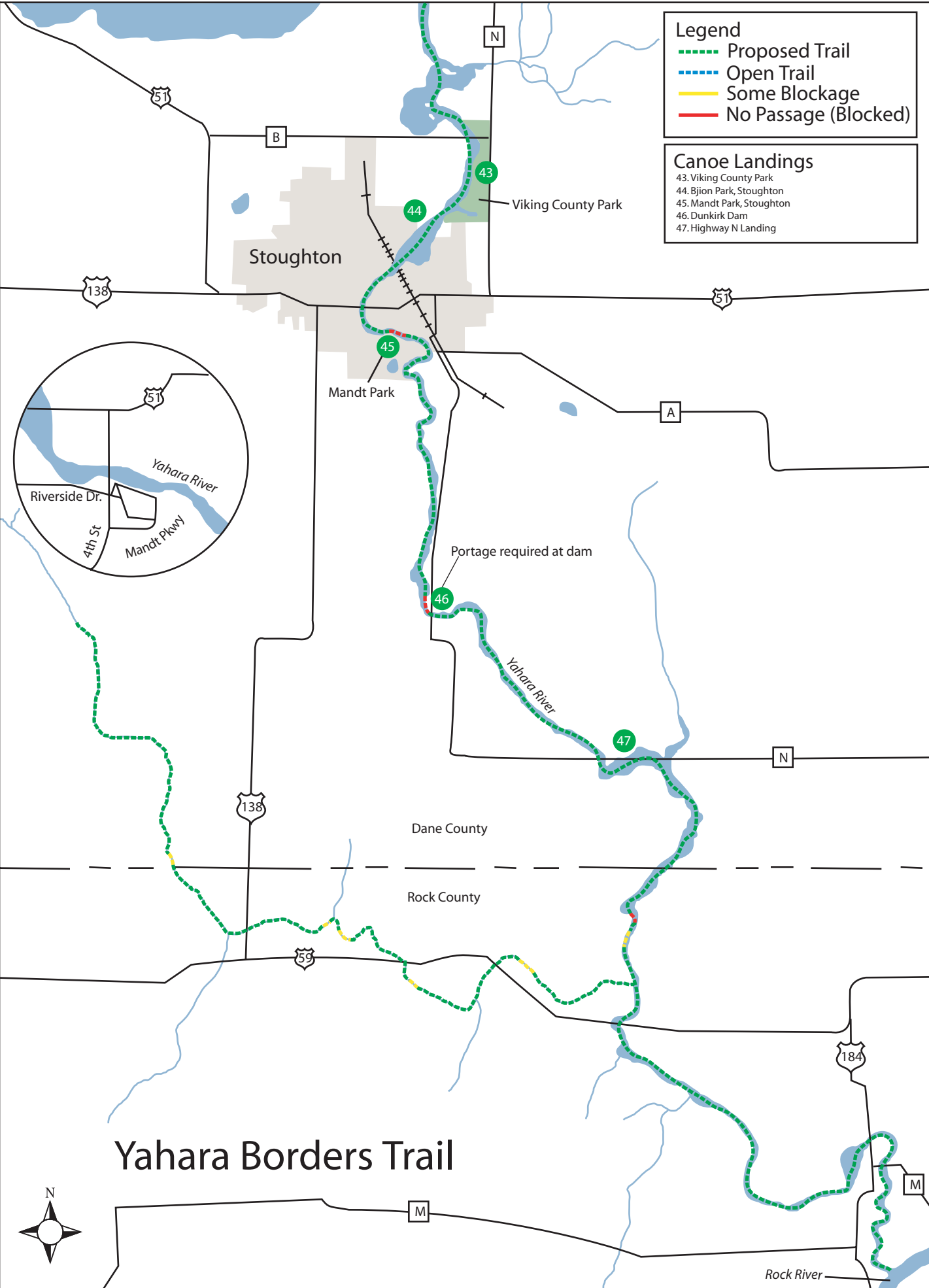

Yahara Borders Trail

Rock River

Mauneshia River Trail

Legend

- Proposed Trail
- Open Trail
- Some Blockage
- No Passage (Blocked)

Canoe Landings

- 61. Riley-Deppe County Park
- 62. Langer Park, Marshall
- 63. Highway TT Landing, Medina
- 64. Deansville State Wildlife Area

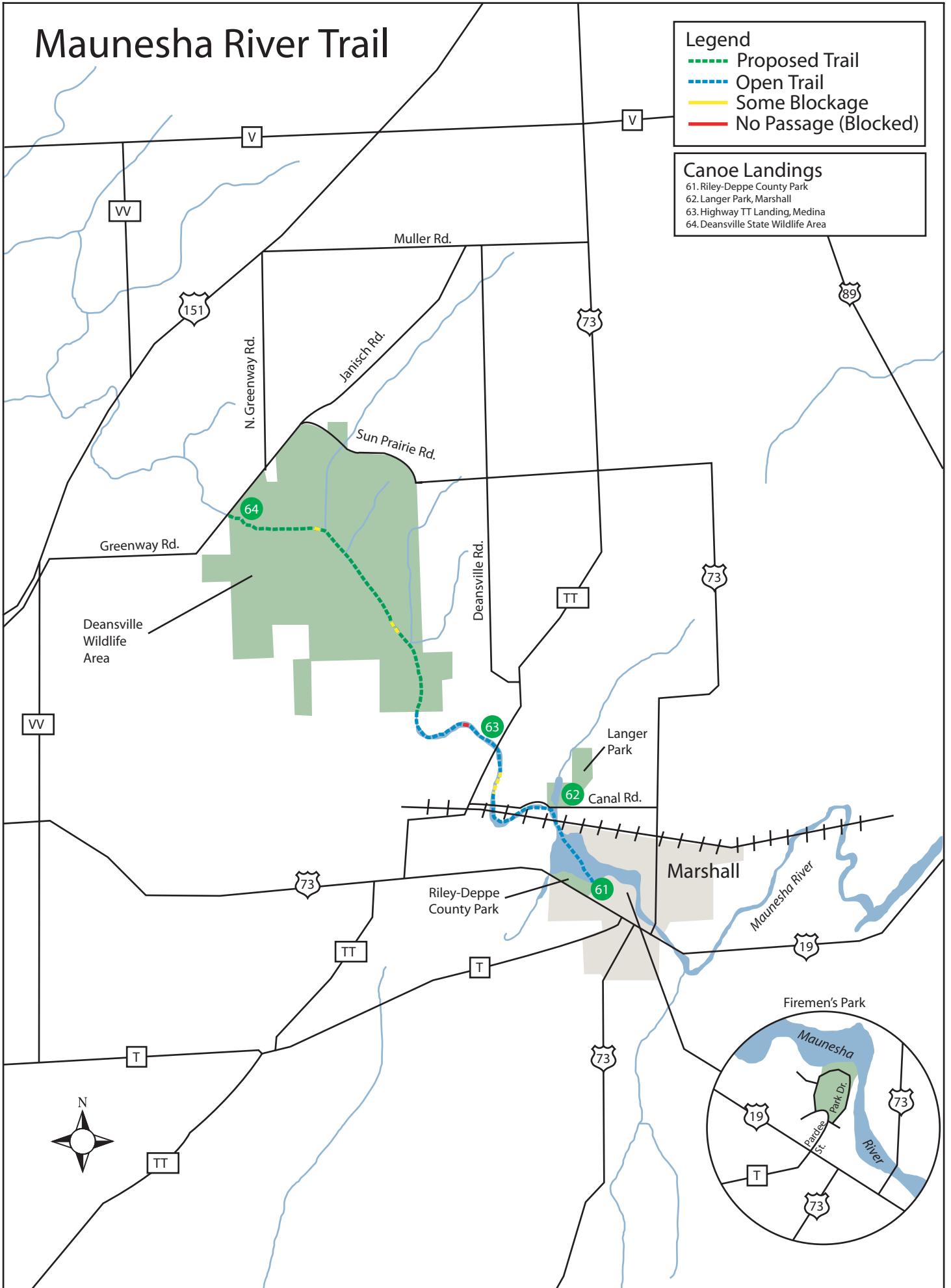

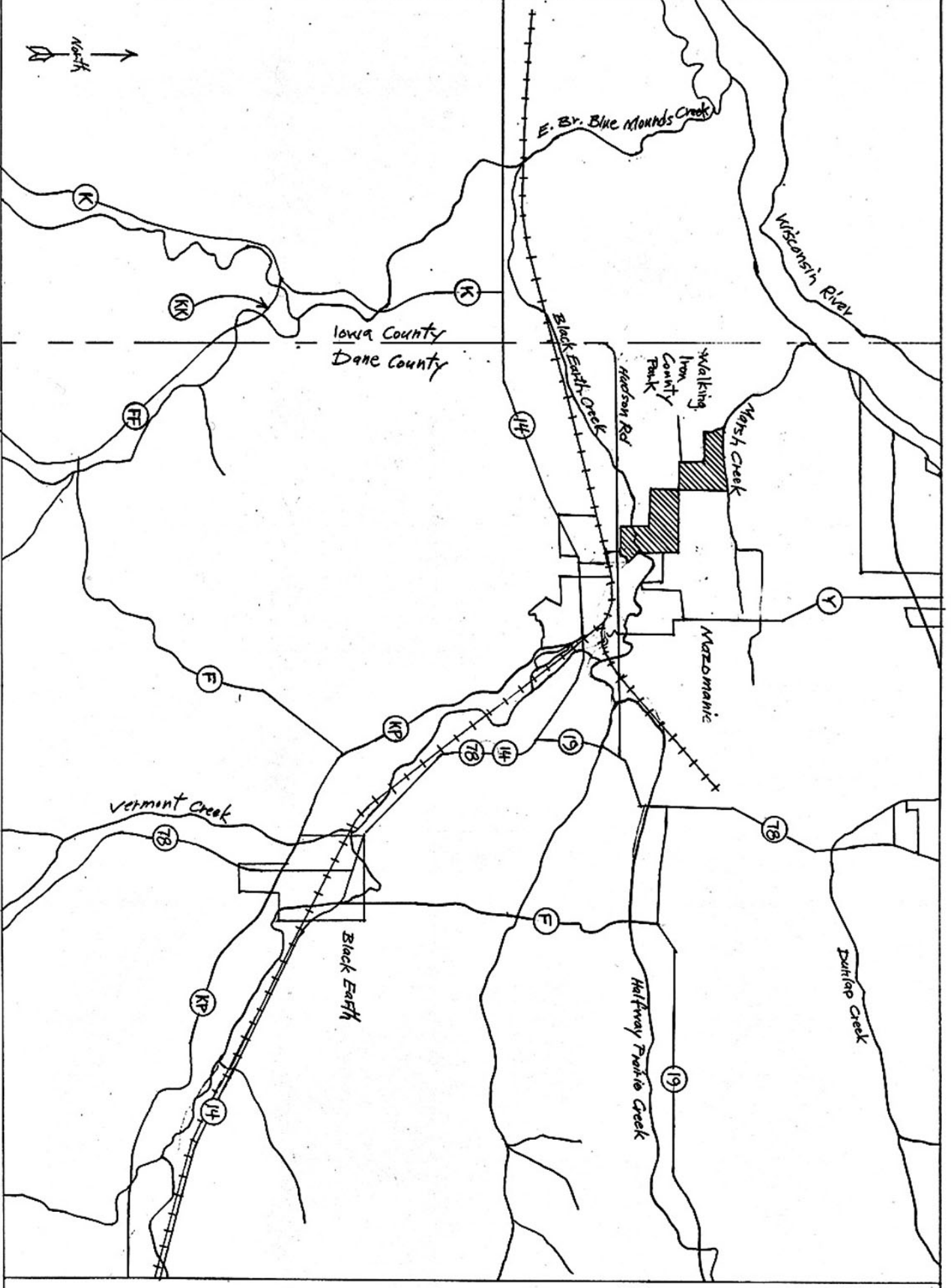
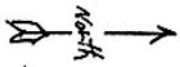

E. Br. Blue Mounds Creek

Wisconsin River

Iowa County
Dane County

Black Earth Creek

Walking Iron
County Park

Marsh Creek

Mazomanie

Vermont Creek

Black Earth

Halfway Pointe Creek

Dunlap Creek

K

KK

K

FP

14

E

KP

78

14

19

78

KP

14

E

78

19

Y

Dane County

PD

M

Verona

Legend

- Proposed Trail (green dashed line)
- Open Trail (blue dashed line)
- Some Blockage (yellow shaded area)
- No Passage (Blocked) (red line)

Canoe Landings

- 68. Valley Road (42.972833, -89.56675)
- 69. Riverside Road (42.958316, -89.5593)
- 51. Paoli Landing (42.93075, -89.532083)
- 53. Frenchtown Road - Montrose (42.891066, -89.53155)
- 54. Belleview Park - Belleville (42.862716, -89.538266)

Sugar River Rd

Valley Rd

Riverside Rd

69

Sugar River

PB

M

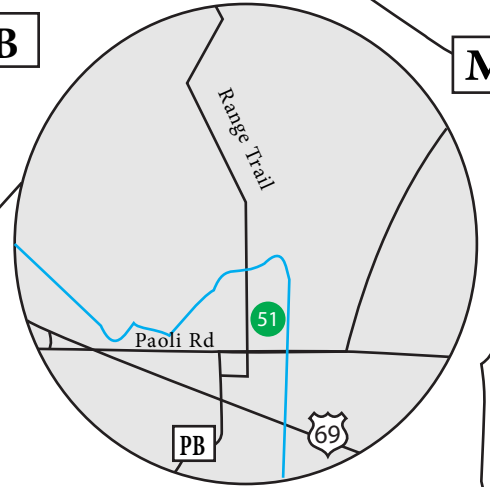

Paoli

51

D

A

PB

A

Frenchtown Rd

PB

69

53

Belleville

D

D

54

DD

92



Dane County

69

69

